

This document is issued by means of a computerized system. The digitally stored original is electronically approved. The approved document has a date entered in the "Approved"-field. A manual signature is not required.

We reserve all rights in this document and in the information contained therein. Reproduction, use or disclosure to third parties without express authority is strictly forbidden.

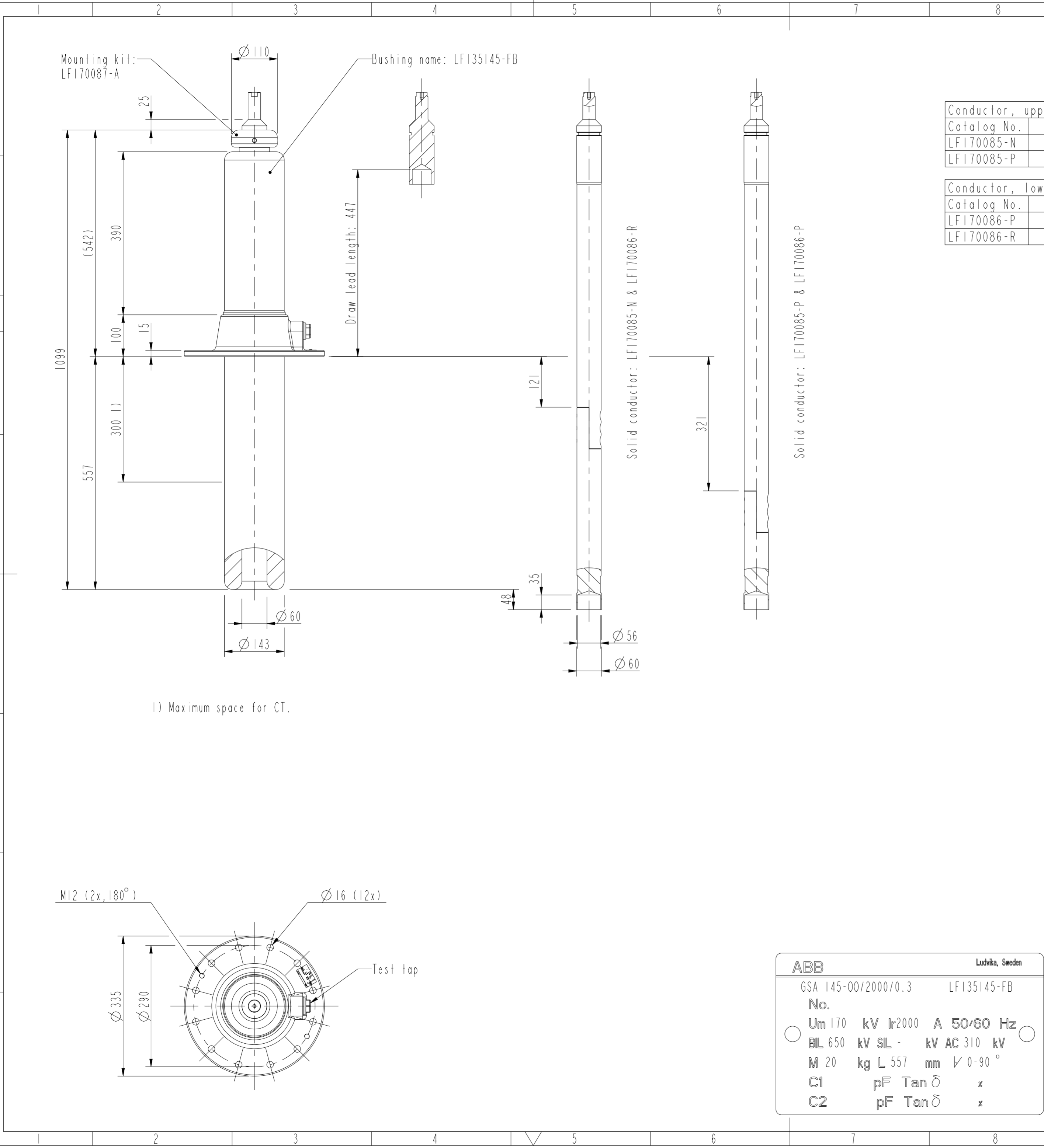

Conductor, upper (Cu)	
Catalog No.	MASS
LFI70085-N	17
LFI70085-P	22

Conductor, lower (Cu)	
Catalog No.	MASS
LFI70086-P	5
LFI70086-R	9

Mass: 3.5 kg

Terminal (Cu)	
Catalog No.	d_cable
LFI70084-A	5
LFI70084-B	11
LFI70084-C	13
LFI70084-D	15
LFI70084-E	18
LFI70084-F	30
LFI70084-G	42
LFI70084-H	45
LFI70084-I	50
LFI70084-J	54
LFI70084-K	5

Revision	Revision text
C	Capacitance updated.

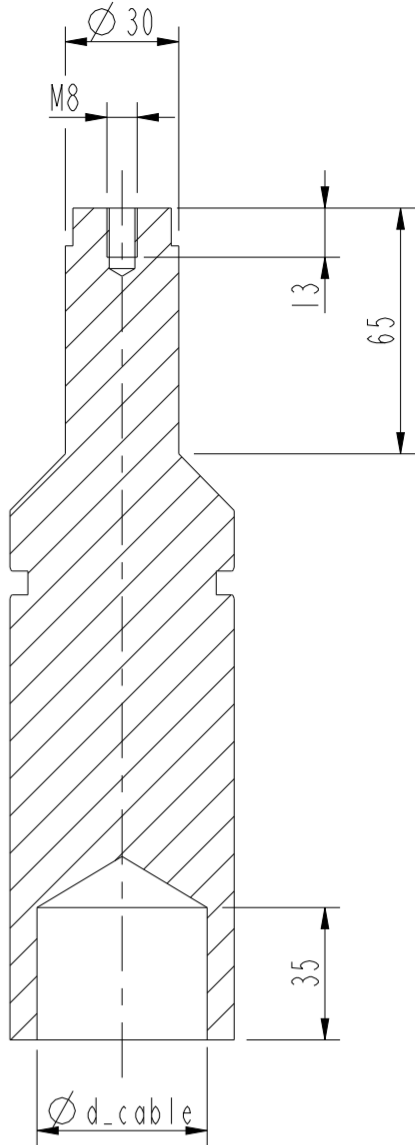

ELECTRICAL DATA acc. to IEC 60137

Ratings	Rated voltage	170	kV
	Max. phase to earth voltage	98	kV
	Max. phase to earth voltage, temporary	170	kV
	Max. current with Cu-conductor	2000	A
	Max. current with stranded cable 1200 mm ²	1600	A
	Dry lightning impulse	650	kV
	Chopped lightning impulse	786	kV
Routine test	Dry power frequency	310	kV
Capacitance	Nominal capacitance	291	pF

GENERAL DATA acc. to IEC 60137

Mass	Mass bushing	20	kg
Cantilever load	Cantilever test load, according to IEC 60137	4000	N
	Max. cantilever operating load, bushing	2000	N
Ambient air temperature according to IEC 60137		-40 to +40	°C
Mounting and service instructions		2750515-138	

ELECTRICAL DATA acc. to ANSI C57.19.00

Ratings	Insulation class	138	kV
	Rated max. line to ground voltage	88	kV
	Max. current with Cu-conductor	2000	A
	Max. current with stranded cable 1200 mm ²	1600	A

Dim. requirements acc. to C57.19.01 not fulfilled

Approved	Document Kind	Based on doc.id	Work order id	Project id
2021-01-25	Dimension Drawing			
Company	Title, Supplementary title			
ABB Technology Ltd	Dimension drawing GSA 145-00 2000/0.3			
Responsible Department	Måttskiss GSA 145-00 2000/0.3			
SEABB-9AAE300824	Document id	2751365-FB	Status	Released
ABB			Revision	C
			Iteration	1/1
			Sheet	1/1